

AS APPROVED BY
KAIPARA DISTRICT COUNCIL
Planning Department

RESOURCE CONSENT
RM200150

21/05/2022 wrobinson

Stage 1 = Lots 1 to 3, Balance Lot 9 and Lot 10 (reserve to vest)
Stage 2 = Lots 4 to 9, Lot 11 (road to vest) and Lot 12 (reserve to vest)

EXISTING EASEMENTS				
Purpose	Shown	Servient Tenement	Dominant Tenement	Created by
R.O.W.	(B)	Lot 9 hereon	Lots 1-8 hereon Lots 2&3 DP444069	8804449.5
R.O.W.	(D)	Lot 3 hereon	Lot 8 DP 511484	10923788.4

EXISTING EASEMENT TO BE REVOKED				
Purpose	Shown	Servient Tenement	Dominant Tenement	Created by
R.O.W.	(B)	Lot 9 hereon	Lots 1-8 hereon Lots 2&3 DP444069	8804449.5

NOTES:
Areas and distances are approximate only and subject to survey.

Comprised In: CT 785378
Total Area: 18.1315ha
3.60ha - Ecological Feature Currently Wetland Planting
2.70ha - Environmental Benefit Extra Dryland Planting
2.89ha - Landscape Re-Vegetation

REVISIONS			
Date	No	Description	Sign
21/6/21	M	Amend Lots 2/8 bdy	LJR
06/7/21	N	Amend Lot 8 drainage	LJR
20/04/22	O	Amend Stage 1	SP
16/05/22	P	Minor amendments Stage 1 & 2	SP

© Lands and Survey Limited Copyright and Conditions of Use:
These drawings shall only be used for the purpose for which they were supplied. Any re-use is prohibited and no part of this document may be reproduced or distributed without the written permission of Lands and Survey Limited or its associate companies.

Proposed Subdivision of Lot 9 DP 511484

Prepared for
HOWARD COLLIER
Black Swamp Rd, Mangawhai

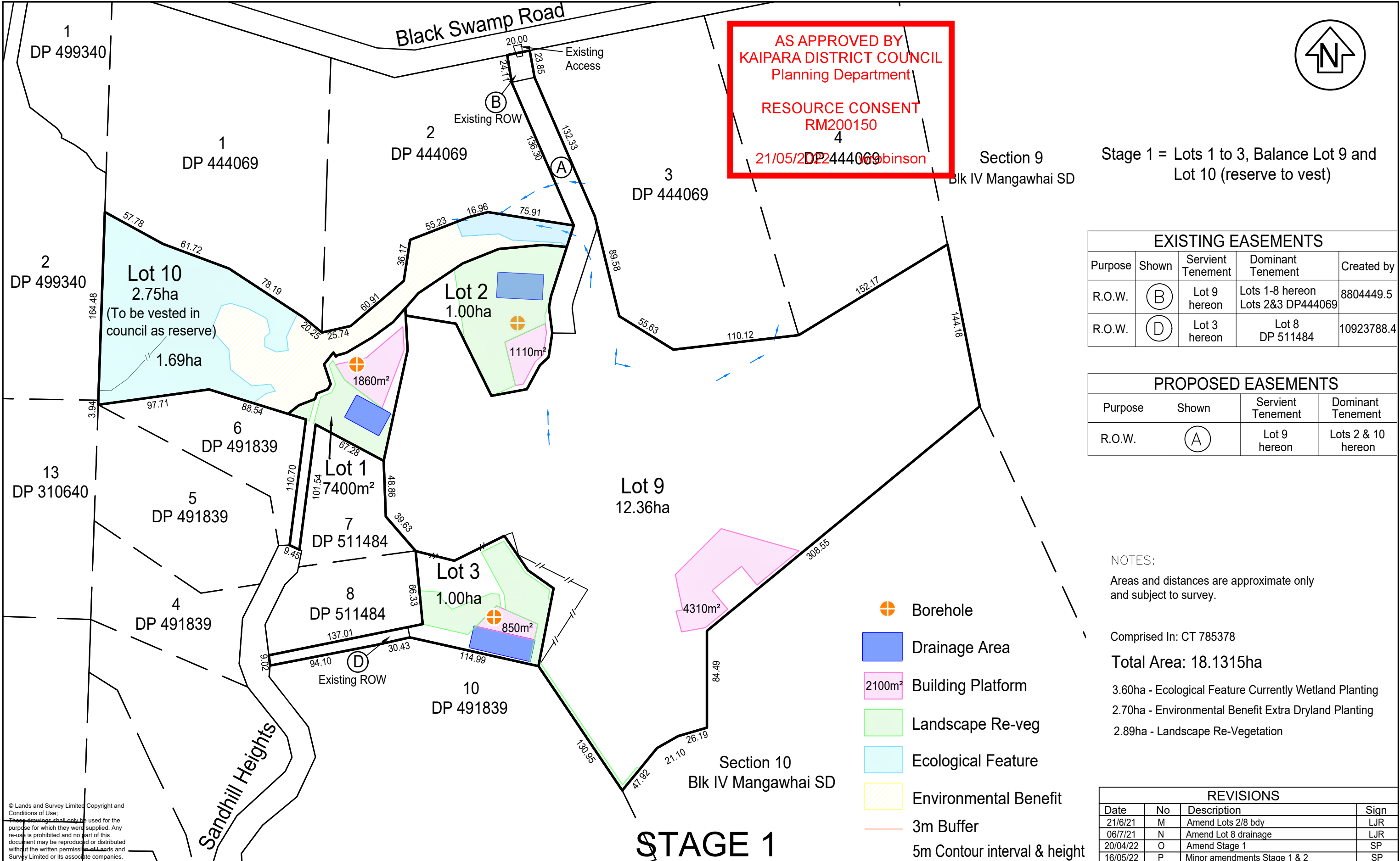

AS APPROVED BY
KAIPARA DISTRICT COUNCIL
Planning Department

RESOURCE CONSENT
RM200150
21/05/2022
J Robinson



Section 9
Blk IV Mangawhai SD
Stage 1 = Lots 1 to 3, Balance Lot 9 and Lot 10 (reserve to vest)

EXISTING EASEMENTS				
Purpose	Shown	Servient Tenement	Dominant Tenement	Created by
R.O.W.	(B)	Lot 9 hereon	Lots 1-8 hereon Lots 2&3 DP444069	8804449.5
R.O.W.	(D)	Lot 3 hereon	Lot 8 DP 511484	10923788.4

PROPOSED EASEMENTS				
Purpose	Shown	Servient Tenement	Dominant Tenement	
R.O.W.	(A)	Lot 9 hereon	Lots 2 & 10 hereon	

NOTES:
Areas and distances are approximate only and subject to survey.

Comprised In: CT 785378
Total Area: 18.1315ha
3.60ha - Ecological Feature Currently Wetland Planting
2.70ha - Environmental Benefit Extra Dryland Planting
2.89ha - Landscape Re-Vegetation

REVISIONS				
Date	No	Description	Sign	
21/6/21	M	Amend Lots 2/8 bdy	LJR	
06/7/21	N	Amend Lot 8 drainage	LJR	
20/04/22	O	Amend Stage 1	SP	
16/05/22	P	Minor amendments Stage 1 & 2	SP	

© Lands and Survey Limited Copyright and Conditions of Use.
These drawings shall only be used for the purpose for which they were supplied. Any re-use is prohibited and no part of this document may be reproduced or distributed without the written permission of Lands and Survey Limited or its associate companies.



EMAIL: info@landsandsurvey.co.nz
WHANGAREI PO Box 744, 164 Bank Street, Tel 09 438 7568
DARGAVILLE (Wed) 97 Victoria Street, Tel 09 439 6634

Proposed Subdivision of Lot 9 DP 511484

Prepared for
HOWARD COLLIER
Black Swamp Rd, Mangawhai

DRAWN	LJR	SCALES	1:3000 (A3)	SHEET	2
DATE	May 2021			SERIES OF	2 of 3
				REF	10184/3/2/P

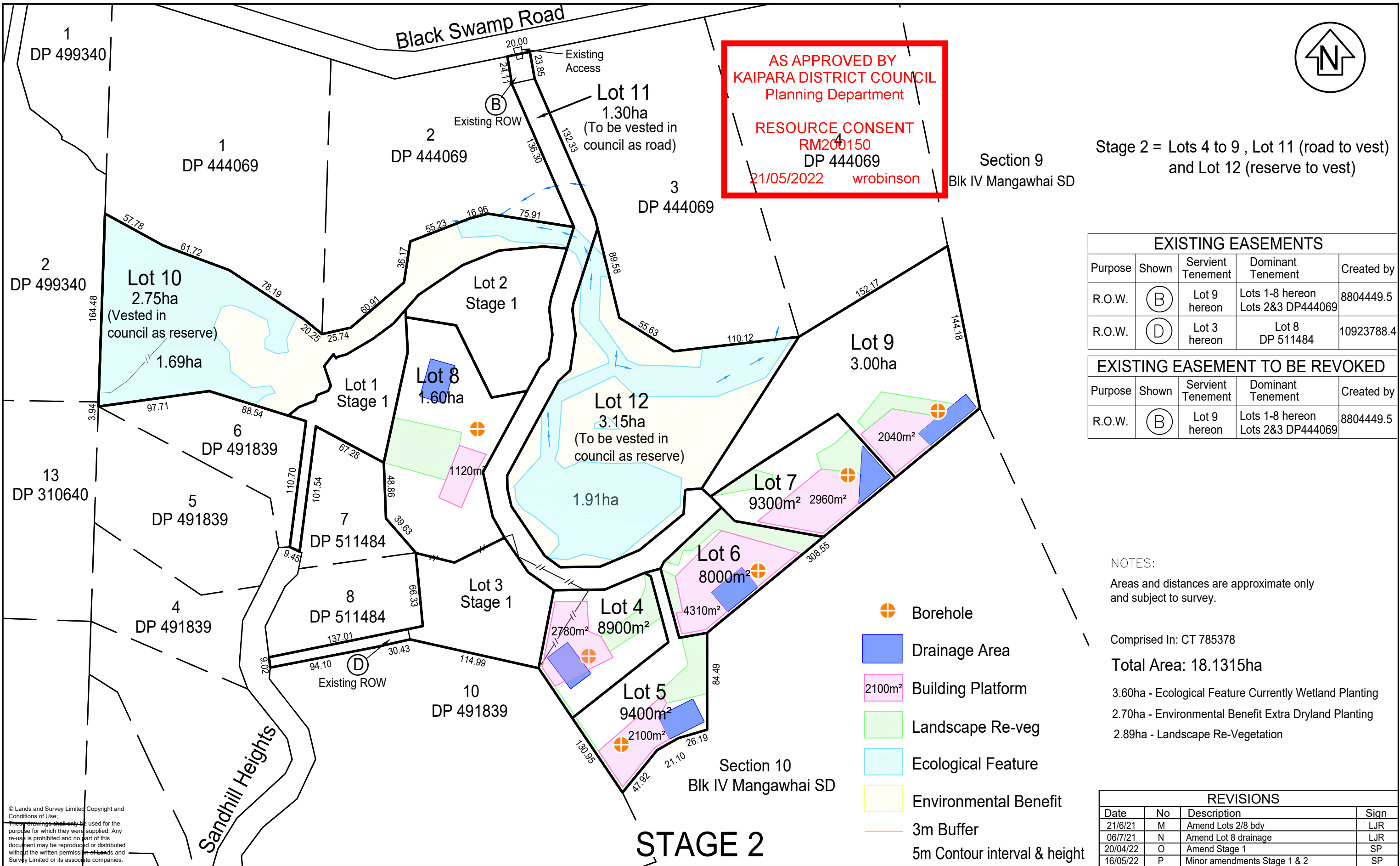

AS APPROVED BY
KAIPARA DISTRICT COUNCIL
Planning Department

RESOURCE CONSENT
RM200150
DP 444069
21/05/2022 wrobinson

Stage 2 = Lots 4 to 9 , Lot 11 (road to vest)
and Lot 12 (reserve to vest)

EXISTING EASEMENTS				
Purpose	Shown	Servient Tenement	Dominant Tenement	Created by
R.O.W.	(B)	Lot 9 hereon	Lots 1-8 hereon Lots 2&3 DP444069	8804449.5
R.O.W.	(D)	Lot 3 hereon	Lot 8 DP 511484	10923788.4

EXISTING EASEMENT TO BE REVOKED				
Purpose	Shown	Servient Tenement	Dominant Tenement	Created by
R.O.W.	(B)	Lot 9 hereon	Lots 1-8 hereon Lots 2&3 DP444069	8804449.5

NOTES:
Areas and distances are approximate only
and subject to survey.

Comprised In: CT 785378
Total Area: 18.1315ha
3.60ha - Ecological Feature Currently Wetland Planting
2.70ha - Environmental Benefit Extra Dryland Planting
2.89ha - Landscape Re-Vegetation

REVISIONS			
Date	No	Description	Sign
21/6/21	M	Amend Lots 2/8 bdy	LJR
06/7/21	N	Amend Lot 8 drainage	LJR
20/04/22	O	Amend Stage 1	SP
16/05/22	P	Minor amendments Stage 1 & 2	SP

© Lands and Survey Limited Copyright and
Conditions of Use:
This drawing shall only be used for the
purpose for which they were supplied. Any
re-use is prohibited and no part of this
document may be reproduced or distributed
without the written permission of Lands and
Survey Limited or its associate companies.

LANDS & SURVEY
SURVEYING | PLANNING | ENGINEERING
EMAIL: info@landsandsurvey.co.nz
WHANGAREI PO Box 744, 164 Bank Street, Tel 09 438 7568
DARGAVILLE (Wed) 97 Victoria Street, Tel 09 439 6634

Proposed Subdivision of Lot 9 DP 511484

Prepared for
HOWARD COLLIER
Black Swamp Rd, Mangawhai

DRAWN	LJR	SCALE	1:3000 (A3)	SHEET	3
DATE	May 2021			SERIES OF	3 of 3
				REF	10184/3/1/P