

Approvals  
 Certified by the Kaipara District Council that the boundary shown hereon is the same as the boundary defined in the Kaipara District Council Resolution dated 11/11/01 pursuant to Section 101M(1) Local Government Act 1974

*[Signature]*  
 15/11/01  
 Kaipara District Council

NOTE:  
 Where a boundary is shown along a river or road it follows the middle line of the physical river or legal road unless shown otherwise.

----- Adjoining Ward/ District Boundary

Sheet 1 of 3

Total Area

Comprised in

I, being a person entitled to practise as a registered surveyor certify that:  
 (a) The surveys to which this district relates are accurate, and were undertaken by me or under my direction in accordance with the Survey Act 1996 and the Survey Regulations 1996.  
 (b) This dataset is accurate and has been created in accordance with the Act and these Regulations

Signed \_\_\_\_\_ Date / /

Field Book p Traverse Book p  
 Reference Plans

Examined \_\_\_\_\_ Correct

I certify that this plan renders the boundary capable of identification under section 101M(3)(b) Local Government Act 1974

*[Signature]* Chief Surveyor

Deposited this.... day of .....

..... for Registrar-General of Land

File Received - 4 MAY 2001  
 Instructions: **SO70435**

Land District : Auckland  
 Survey Block & District :  
 NZMS 261 Sheet Record Map No.

**DARGAVILLE WARD**

TERRITORIAL AUTHORITY: Kaipara District Council  
 Surveyed by: Terralink Ltd  
 Scale 1:20,000 Date: February 2001

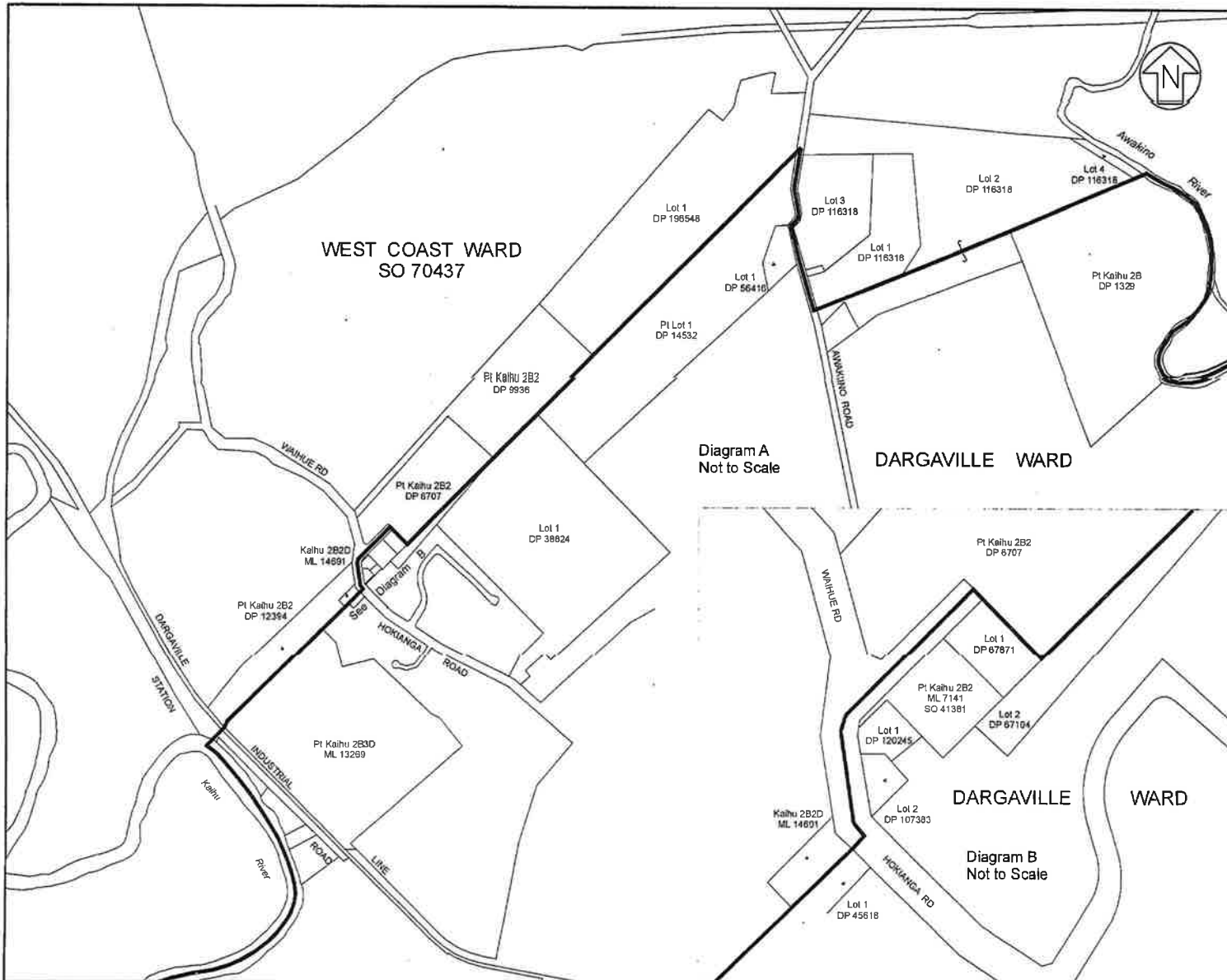

Approvals  
 Certified by the Kaipara District Council that the boundary shown herein is the same as the boundary defined in the Kaipara District Council resolution dated 11/10/99 pursuant to Section 101M(1) Local Government Act 1974

*Johnston* 10/10/01

NOTE:  
 Where a boundary is shown along a river or road it follows the middle line of the physical river or legal road unless shown otherwise.

Adjoining Ward/ District Boundary

Sheet 2 of 3

Total Area  
 Comprised in

I, being a person entitled to practise as a registered surveyor certify that:  
 (a) The surveys to which this dataset relates are accurate, and were undertaken by me or under my direction in accordance with the Survey Act 1986 and the Survey Regulations 1988  
 (b) This dataset is accurate and has been created in accordance with the Act and those Regulations.

Signed \_\_\_\_\_ Date / /

Field Book p. Traverse Book p.  
 Reference Plans  
 Examined \_\_\_\_\_ Correct \_\_\_\_\_

I certify that this plan renders the boundary capable of identification under section 101M(3)(b) Local Government Act 1974

Johnston Richard Chief Surveyor  
 Deposited this... day of .....

..... for Registrar-General of Land

Land District : Auckland  
 Survey Block & District :  
 NZMS 261 Sheet Record Map No.

**DARGAVILLE WARD Diagram Sheet 1**

TERRITORIAL AUTHORITY: Kaipara District  
 Surveyed by  
 Scale: Not to scale Date: February 2001

File Received - 4 MAY 2001  
 Instructions: **SO70435**

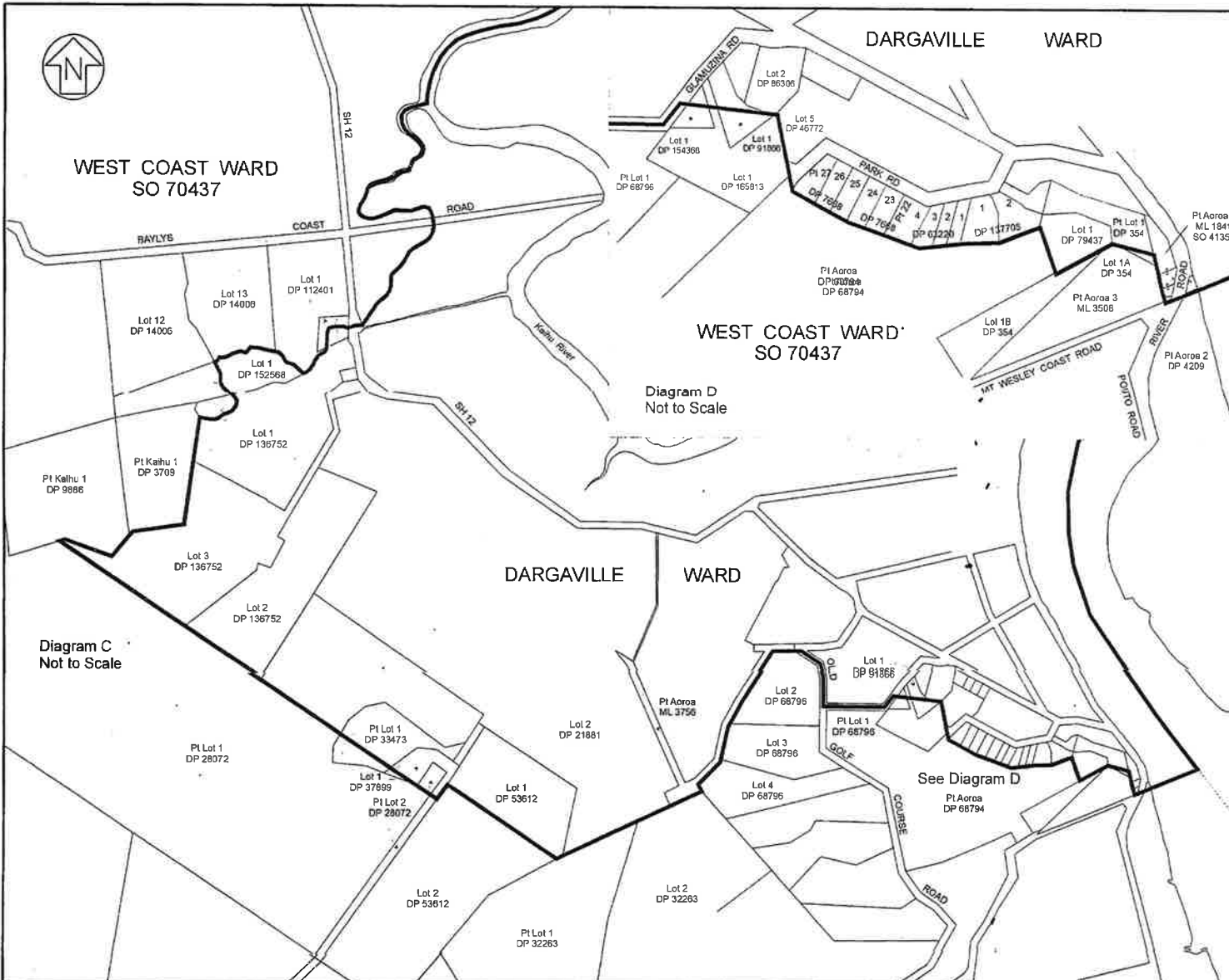

Approvals

Certified by the *Kaipara District Council* that the boundary shown hereon is the same as the boundary defined in the *Survey Act 1988* Resolution dated *11/12/00* pursuant to Section 101M(1) Local Government Act 1974

*Jh-Lobok* 10/1/01  
Kaipara District Council

NOTE:  
Where a boundary is shown along a river or road it follows the middle line of the physical river or legal road unless shown otherwise.

..... Adjoining Ward/ District Boundary

Sheet 3 of 3

Total Area

Comprised in

I, being a person entitled to practise as a registered surveyor certify that:

(a) The surveys to which this dataset relates are accurate, and were undertaken by me or under my direction in accordance with the Survey Act 1988 and the Survey Regulations 1998.

(b) This dataset is accurate and has been created in accordance with the Act and those Regulations.

Signed \_\_\_\_\_ Date / /

Field Book p Traverse Book p  
Reference Plans

Examined \_\_\_\_\_ Correct \_\_\_\_\_

I certify that this plan renders the boundary capable of identification under section 101M(3)(b) Local Government Act 1974.

*L. G. J. P. J.* Chief Surveyor

Deposited this.... day of .....

Land District : Auckland  
Survey Block & District :  
NZMS 261 Sheet Record Map No.

**DARGAVILLE WARD Diagram Sheet 2**

TERRITORIAL AUTHORITY: Kaipara District  
Surveyed by  
Scale: Npt to scale Date: February 2001

..... for Registrar-General of Land  
File Received MAY 2001  
Instructions: **SO70435**