



Pou Tu o Te Rangi, Harding Park and Old Mount Wesley Cemetery Reserve Management Plan September 2022

Mihi

Tuia ki te rangi, tuia ki te whenua, tuia ki te herenga tangata

The binding of the sky, the land and the tethering together with the people

Ka rongo te po, ka rongo te Ao

Listening to the voices of knowledge and enlightenment

Putā ki te wheiao ki te ao marama, tihei mauriora

Entering into the world of light and well-being of all people

Maunganui titiro ki Tutamoe, Tutamoe titiro ki Tangihua, Tangihua titiro ki Mangaraho, Mangaraho titiro ki Tokatoka.

Ko enei nga Maunga nga Puke o ngā wāhi I tata mai ki Pou Tu o Te Rangi Pā site

Maunganui, Tutamoe, Tangihua, Mangaraho, and Toka Toka are the mountains and significant hillsides that are near and surrounds Pou Tu o Te Rangi Pā site

Ko Te Roroa, Te Kuihi, Te Parawhau, Te Uri O Hau, Ngati Whatua nga Hapu nga Iwi o tenei Rohe.

Te Roroa, Te Kuihi, Te Parawhau, Te Uri O Hau and Ngati Whatua are the Hapu and Iwi of this area.

No reira tena ra koutou katoa.

Greetings to all.



Ngā Kaupapa / Contents

He Kupu Whakataki / Introduction

Part 1 Background and Context

Location and property details

Site description

History

Co-Governance

Te tirohanga / Vision

Part 2 – Management Aspirations

Cultural, historic and archaeological values

Kōrero tuku iho and tikanga

Landscape values and views

Ecological values and biodiversity

Specimen trees and amenity planting

Recreation and use

Access, linkages and connectivity

Partnerships

Licences and permits

Part 3 – Summary and Concept Plans

Concept plans

Summary of actions

Review considerations

He Kupu Whakataki / Introduction

This Plan is prepared under the Reserves Act 1977 for three reserves Pou Tu o Te Rangi, Harding Park and the Old Mount Wesley Cemetery, collectively referred to as the Park. The Plan sets out a vision for this Park and directs its future management and development. This document serves as the Reserve Management Plan for these reserves.

The vision for this Park is:

Ko Pou Tu o Te Rangi me Harding Park ētahi wāhi hirahira, harikoa, wāhi mīharo ki te ako ki ngā mea taiao me ngā taonga tuku iho mō te Hapori whānui me ngā manuhiri.

Putā noa i te wāhi nei, ka kite i nga pūrākau e korero ana mō ngā momo ahurei o te whenua, te hapori ano hoki; mai ngā wā i mua, ki ēnei rā, puta noa.

He wāhi ēnei ka tohaina e hora nei ma te marea hei papa rēhia, pureitanga, hari me te ako.

Pou Tu o Te Rangi and Harding Park will be an important enjoyable learning environment, rich in natural and cultural heritage for both local community and visitors.

Throughout the site stories will be expressed hinting at the unique qualities of this place and this community; past, present and future.

Pou Tu o Te Rangi and Harding Park will be a shared public place for recreation, events, fun and learning.

The Park is located on a hill overlooking Dargaville and the Northern Wairoa River. The prominence of this point as a lookout made it a strategic place for Māori settlement, ultimately arising as the Pou Tu o Te Rangi Pā which remains a commanding feature of this site.

The Park is also home to the Dargaville Museum and Kaipara Heritage Machinery Museum who further tell the stories of this area and its people. The Old Mount Wesley Cemetery provides a tranquil place for reflection and contains the graves of many early settlers.

In addition, the Park contains areas of native bush, mountain bike tracks, the Lighthouse Function Centre, walking tracks, picnic areas and overnight caravan parking. This blend of panoramic views, stories from the past and recreation, creates a park that attracts visitors from near and far.

The purpose of this Plan is to:

- Set out the overarching vision for the Park.
- Recognise the cultural and historical significance of sites within the Park.
- Be a comprehensive document that covers Pou Tu o Te Rangi, Harding Park and the cemeteries in an integrated way.
- Satisfy the statutory requirements of the Reserves Act 1977.
- Provide background and context to the Park.
- Guide the future management and development of the Park.
- Provide a policy framework, including objectives and policies for activities and development.
- Provide sufficient detail, including actions points and concept plans to guide the use and development of the Park.

This Plan is presented in three parts:

Part 1 – provides background and context to the Plan. It confirms the legal classification of the reserves and includes an explanation of the statutory and strategic framework of this Plan.

Part 2 – contains the management aspirations for the Park. These are set out under objectives which contain the desired goals and outcomes of the Plan. It also includes policies to ensure the objectives are met, along with a list of actions to guide implementation.

Part 3 – includes a summary of the actions and concept plans that illustrate potential development in accordance with the Plan’s actions. This section also outlines the review process for this Plan.



Part 1 - Background and Context

Location and property details

The Park is located to the south of Dargaville town centre on the western bank of the Northern Wairoa River. The location of the Park in the context of the wider environment is shown in Figure 1.

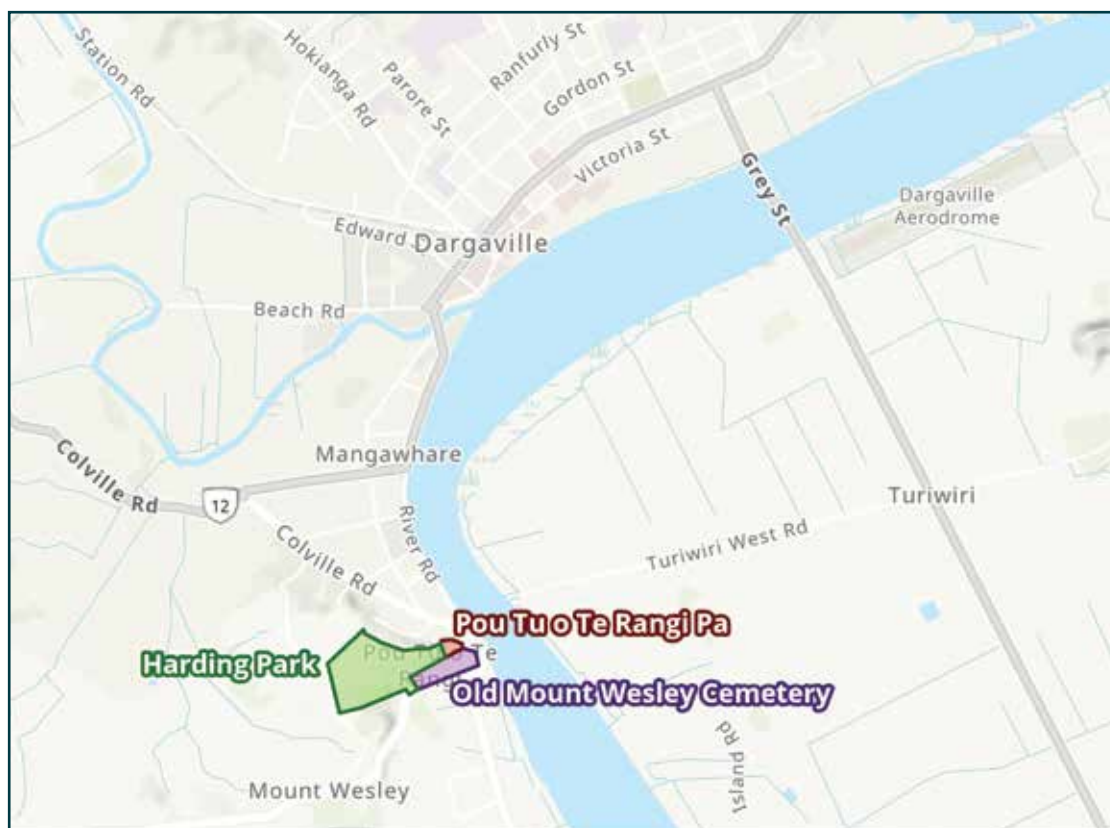

Figure 1 - Location of the Park in its wider environment

The property details including legal description, site area and administering body for each parcel of land covered by this Plan are outlined in Table 1 below. Figure 2 illustrates the reserves that are covered by this Plan.

Name	Legal Description	Area	Administering Body
Pou Tu o Te Rangī	Lot 1 DP 79437	5,793m ²	Pou Tu o Te Rangī Joint Management Committee
Harding Park	Part Aoroa Block	11.9994 ha	Kaipara District Council
Old Mt Wesley Cemetery (Including the Harding Family Cemetery)	Lot 1A, 1B Deposited Plan 354	1.1837 ha	Kaipara District Council
	Marked Cemetery Deposited Plan 354	1.6086 ha	Kaipara District Council
	Part Aoroa No. 3 Block	2,985m ²	Kaipara District Council

Table 1 - Property details for the reserves covered by this Plan



Figure 2 - Property boundaries of the reserves covered by this Plan

Reserve Classifications

Reserves held under the Reserves Act 1977 are given a classification under that Act and must be managed in accordance with that classification. The reserves that comprise the Park have the following classifications under the Act:

Name	Gazetted Purpose
Pou Tu o Te Ranghi	Historic Reserve
Harding Park	Local Purpose (Site for a Museum) Reserve
Old Mt Wesley Cemetery and Harding Family Cemetery	Local Purpose (Cemetery) Reserve

Table 2 - Reserve Classifications

Despite having different administering bodies and different classifications, the intention for many years has been to manage these reserves as one Park. To that end, the Park is managed by two committees who share the same membership and often hold joint meetings. More information on these committees is given in the co-governance section of this Plan.

Because the reserves that constitute the Park have different administering bodies, they cannot be managed under a single Reserve Management Plan under the Reserves Act 1977. This Plan has therefore been prepared to meet the requirements under the Act, sufficient to serve as both the Reserve Management Plan for Pou Tu o Te Ranghi Historic Reserve and Harding Park, including the cemeteries. In effect, it is two Reserve Management Plans under one cover page. Creation of this Plan has therefore been overseen jointly by the Pou Tu o Te Ranghi Joint Management Committee, Harding Park Committee and Kaipara District Council.

From the perspective of the community however, these reserves are seen as a single Park with a range of historic, scenic and recreational offerings.

This Plan therefore intends to provide a holistic approach to management of the reserves and cemeteries, while acknowledging the different reserve classifications and the statutory requirements of the Reserves Act 1977.

Site description

The Park is a popular destination for residents of Dargaville and visitors to the district. The Park caters for a range of existing uses and offers the following features and attractions:

- Extensive views over Dargaville, the Northern Wairoa River and surrounding countryside
- Pou Tu o Te Rangī - ancestral Pā of Te Uri o Hau
- Dargaville Museum - Te Whare Taonga o Tunatahi
 - o Museum display hall and gift shop
 - o Replica gumdiggers' camp
 - o The masts of the Rainbow Warrior
 - o Lighthouse Function Centre
 - o An overnight campervan parking area
- Kaipara Heritage Machinery (Dargaville) Inc
 - o Museum buildings, display hall and workshops
 - o Historic sheep shearing shed
- Old Mount Wesley Cemetery
 - o Sextons building
 - o Historic and operational cemetery
- Mountain bike tracks
- Pou whenua at entrance
- Walking tracks
- Picnic areas

Existing Park infrastructure and assets include:

- Loop road
- Car parking areas
- Public toilets
- Caravan dump station
- Walking tracks
- Manmade stormwater pond (that is used for fire fighting and rural fire fighting training purposes)
- Amenity planting
- Park furniture (picnic tables etc.)
- Signage (way finding and interpretative signage)
- Telecommunications tower

Existing Licences to Occupy

- Dargaville Museum - Te Whare Taonga o Tunatahi
- Kaipara Heritage Machinery (Dargaville) Inc.

History

Pou Tu o Te Rangi Pā

The first known occupants of this Pā are the Ngāti Rangi people. They are a hapū of the Ngāti Awa iwi.¹ When the Ngāti Whātua waka, Mahuhu ki Te Rangi landed in the Kaipara approximately 1250AD the Ngāti Awa iwi were well established around the Kaipara.

After the drowning of Rongomai, the Ariki of the Mahuhu Ki Te Rangi waka, his son Te Po took the waka north to Rangaunu harbour, its final resting place. Over three centuries the ancestors of the Ngāti Whātua people lived in the Victoria Valley south of Kaitaia before migrating South to the Hokianga, then into the Kaihu Valley and eventually back into the Kaipara.²

During the period of Ngati Whatua's migration from the Kaihu Valley back into the Kaipara, Tutaki a Ngati Whātua Rangatira married Kahurau who was of Ngati Rangi descent. Mahanga a Ngati Rangi Rangatira who was living at maunga raho attacked Tutaki's people living at Pou Tu Te Rangi Pā. Mahanga's wife Waihekeao was Tutaki's daughter. Tutaki had taken Waihekeao home with him after being insulted by Mahanga. Haumoewarangi came along, abducted Waihekeao and eventually married her. Mahanga wanted to punish Tutaki for allowing this to happen. Many people were killed and enslaved by Mahanga when the battle took place at Tutaki's Pā, Pou Tu Te Rangi. Haumoewarangi sought utu and engaged Mahanga in several battles, the first he lost, the second he won. However, Mahanga escaped with 100 of his own people and 100 slaves from Pou Tu Te Rangi Pā.

It was some of these slaves that eventually drowned Mahanga and his people whilst fishing in the Wairoa River. They rowed off in the wakas leaving Mahanga and his people standing on their fishing nets on the sand bank near Tauhara Pā called "Te Wai a Mahanga" after this incident.³

The Ngati Awa iwi which includes the Ngati Rangi hapū, left the Kaipara after a series of battles lead by Haumoewarangi's elder brother Rangiwahapapa, when Te Hana a woman of Ngati Awa and Te Arawa descent who was betrothed to him in marriage, swam across the harbour to live with a Ngati Awa rangatira.⁴ Since Haumoewarangi's time, (Tupuna of the Te Uri O Hau People), Te Uri o Hau have claimed mana over Pou Tu Te Rangi Pā which was recognised in the 2002 Te Uri o Hau Treaty Claims Settlement. Ngati Kawa and Ngati Whiu are Te Roroa hapū that whakapapa to Ngapuhi. These hapū lived in the Dargaville area and also have a connection to Pou Tu Te Rangi Pā. During the land sales in the 1870's Te Uri o Hau, Ngati Kawa and Ngati Whiu were acknowledged as having mana over the surrounding lands of Pou Tu Te Rangi. Pou Tu Te Rangi is the month of March on the Māori Maramataka (calendar). It is also a star known as Altair.⁵

Source: *Mikaera Miru, Te Uri o Hau, June 2011*

1 Gary Hooker, Te Roroa Historian

2 Mana Whenua report: Te Uri o Hau Te Wahapu o Kaipara; William Wright 1996

3 The Story of Mahanga by Tamati Whakatara (Ngati Rangi and Ngati Kawa descent) Translated by Percy Smith.

4 Mana Whenua report: Te Uri o Hau Te Wahapu o Kaipara; William Wright 1996

5 Work of the Gods by Kay Leather and Richard Hal

Harding Park

In 1902 the site of Harding Park was donated for a hospital site. Following debate around whether this was the best site for the hospital it was decided to locate the hospital at Te Kopuru. Therefore in 1908 this land was gifted as a scenic reserve.

Harding Park was gazetted as a 'public reserve' (site for museum) under the Reserves Act in 1982.

The land previously used for forestry is now home to the Dargaville Museum, which was originally established in the old stables behind the Dargaville Homestead, Normanby Street in the early 1960's, then known as the Dargaville Public Museum, operated by a trust. In 1978 it moved to a room in the Municipal Chambers. A year prior, the trust was replaced by the Northern Wairoa Māori, Maritime and Pioneer Museum Society Incorporated.

'In 1979 the society's committee decided to site the museum in Harding Park. Because the land carried a reserve designation it was necessary for an act to be passed in Parliament changing the land designation for use as a museum site. Work started on Stage one in 1982. A massive undertaking of landscaping and leveling got into full swing. A long knife-edge ridge running along the top of the land was lowered by five metres and 8000m³ of soil was rearranged to form the current landscape.

Stage one foundations were laid in 1983. In 1985 this was opened by Governor-General Sir David Beattie who became the society's patron. Stage two, the Lighthouse Function Centre was finished in 1988 with Stage 3 the Pioneer Hall finished in 1991, Stage 4 the Maritime Hall and workshop (now the Collections Hall) in 1995. The Gum Hall was opened in April 2001. The workshop was erected in 2002 and the Archives extended (this was part of stage 4) in 2004.

The old Aratapu Library built in 1874 and situated in Heawa Road Aratapu. In the 1970's it was moved to the Museum site in Normanby Street. When the Museum was built at Harding Park the old library building was donated to the IHC group at Awakino Point. This building and land went into private ownership and the building tendered out. The Museum, with the help of local donations, brought the building back and installed it on the Museum site in 2006/07.

The railway building came from Te Wharau railway siding via Avoca sand yard where it was used as a tool shed until being offered to the Museum about 4 years ago'.⁶

The Rainbow Warrior masts located in the front of the Museum were bought for \$2,000.00 after the sinking of the Greenpeace ship, the 'Rainbow Warrior' in downtown Auckland Harbour on 10th July 1985.

The Park is also home to the Kaipara Heritage Machinery Museum, establish in August 2001. The Museum's mission is to acquire, restore and display past machinery. Many of it's exhibits relate to the past history of the Kaipara.

Old Mount Wesley Cemetery and Harding Park Family Cemetery

Council records indicate that the Old Mount Wesley Cemetery was established in circa 1885, when a grant for fencing the cemetery was made by the secretary of the Mount Wesley Cemetery Trustees. The earliest grave is dated 1870.

Harding Park Family Cemetery is still operational, with limited plots available.

6 Information provided by the Dargaville Museum (errors and omissions accepted)



Archaeological sites and historic places

Pou Tu o Te Rangi Pā

Pou Tu o Te Rangi Pā is an archaeological site recorded with the New Zealand Archaeological Association (P07/01).

The archaeological features of the Pā include the main defended area, the raised defended area, pits and terraces, features to the east outside of the main defended area of the Pā and archaeological features on the northern side on private land. Only one portion of the two defensive ditches is shown on the plan and is likely that the ditches were obscured by scrub when the site was mapped in 1979. These features are shown in Figure 3 below.

An archaeological assessment prepared by Archaeology North, 2007 states:

“The site is located on a level ridge which slopes towards the Wairoa River. The Pā covers an area of about 100m x 60m. The side is well defended with steep sides of the ridge. Providing defences except on the uphill side where a system of two well defined ditches and a high bank are present. Although partly infilled the defensive ditches are deep and well defined. A causeway was built across the ditches during the logging in the 1970s and a gap was also cut in the defensive bank.

A large terrace in the centre of the Pā looks like the possible location of a big house (whareniui).

A secondary raised defended area protected by steep scarps and a ditch inside the Pā providing a distinctive platform on the northeast corner of the Pā.

Large terraces appear to extend along the southern side of the Pā with three pits recorded at about the mid-point, but the terraces are obscured by thick scrub which conceals the archaeological features. A small, raised platform is located at the eastern end of the Pā. Another small defensive ditch is possible present here, but the area is under weeds and scrub”

There may also be un-recorded archaeological sites associated with the Pā. The archaeological assessment 2007 notes that there are likely to be archaeological remains associated with the occupation of the pā located to the south of the pā within the historic Mount Wesley Cemetery, and located at the lower level on the north side of the Pā on private land.

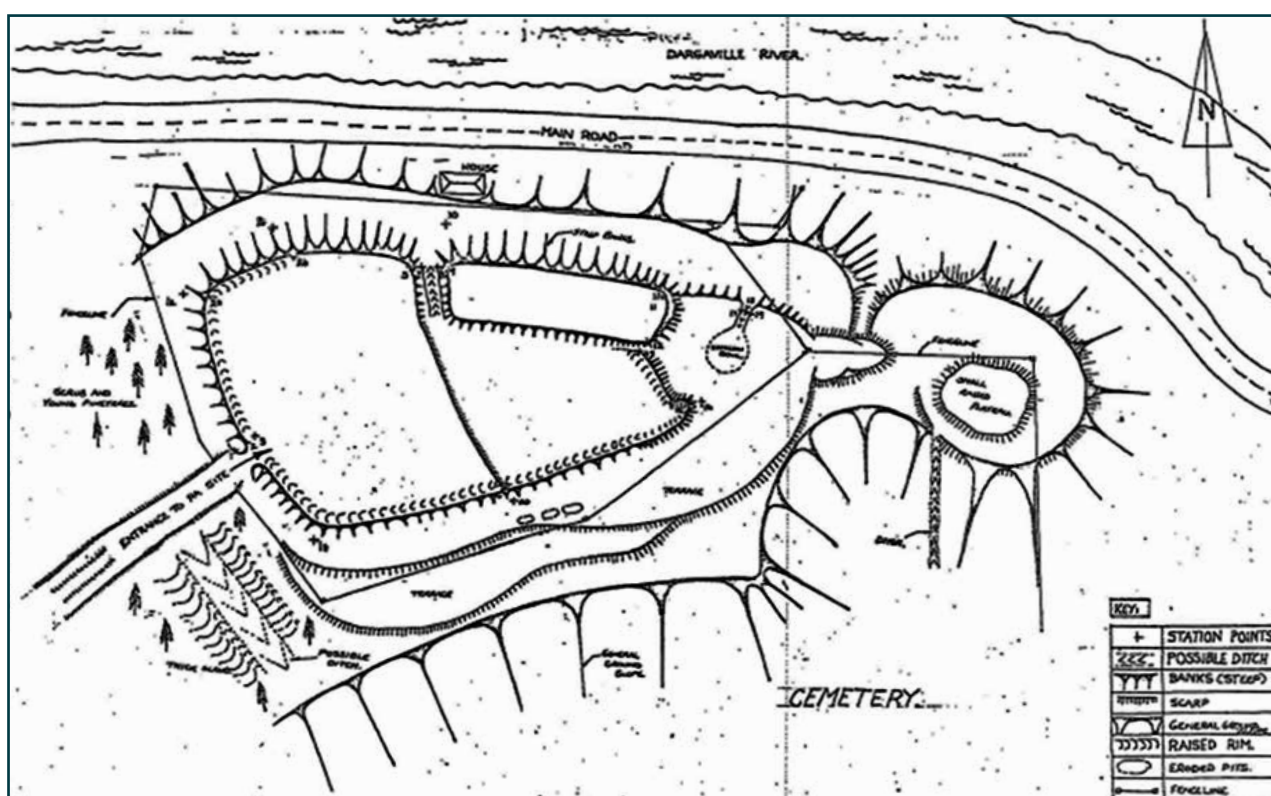

Figure 3 - Plan showing archaeological features at Pou Tu o Te Rangi Pā

Old Mount Wesley Cemetery

Given the cemetery dates to pre-1900, it is likely that the cemetery contains archaeological sites.

Historic Places

The following park features are Category 2 Historic Places listed with Heritage New Zealand Pouhere Taonga.

- Gumdiggers Hut – located within the Museum.
- Aratapu Public Library (Former) – part of the Museum complex.



Aratapu Public Library (Former)



Gumdiggers Hut



Pou Tu o Te Rangī Pā

Co-governance

Pou Tu o Te Rangi is owned by Environs Holdings Limited, a subsidiary of Te Uri o Hau Settlement Trust, and managed by the Pou Tu o Te Rangi Joint Management Committee. This Committee comprises three members nominated by Te Uri o Hau governance entity and three members nominated by KDC. The Committee was established under Section 33(5) of the Te Uri o Hau Claims Settlement Act 2002. This Committee currently comprises of three representatives from Te Uri o Hau, two KDC Councillors and a representative from the Harding family.

Harding Park is owned and managed by KDC. The Old Mount Wesley Cemetery and the Harding family cemeteries are also administered by KDC. Harding Park and the cemeteries are managed by the Harding Park Committee (a KDC sub-committee) with nominated Council representatives.

There is currently an arrangement between the Pou Tu o Te Rangi Joint Management Committee and the Harding Park Committee that KDC appoint the same members to sit on the Harding Park Committee as sit on the Pou Tu o Te Rangi Joint Management Committee. The two committees hold combined meetings and mostly function as one committee. In this way, the Park is effectively co-governed by Te Uri o Hau and Council.

Te tirohanga - Vision

The vision for the Park is:

Ko Pou Tu o Te Rangi me Harding Park ētahi wāhi hirahira, harikoa, wāhi mīharo ki te ako ki ngā mea taiao me ngā taonga tuku iho mō te Hapori whānui me ngā manuhiri.

Putā noa i te wāhi nei, ka kite i ngā pūrākau e korero ana mō ngā momo ahurei o te whenua, te hapori ano hoki; mai ngā wā i mua, ki ēnei rā, puta noa.

He wāhi ēnei ka tohaina e hora nei ma te marea hei papa rēhia, pureitanga, hari me te ako.

Pou Tu o Te Rangi and Harding Park will be an important enjoyable learning environment rich in natural and cultural heritage for both local community and visitors.

Throughout the site stories will be expressed hinting at the unique qualities of this place and this community; past, present and future.

Pou Tu o Te Rangi and Harding Park will be a shared public place for recreation, events, fun and learning.



Part 2 – Management Aspirations

This part gives direction on how the Park is to be managed and developed. This section is intended to be aspirational, aiming for the future we want to work towards, even if some aspirations are beyond what is achievable within Council and Te Uri o Hau's current budgets. The actions listed are intended to move the Park closer to the state being aspired to.

In addition, the objectives and policies in this part can be used to test future proposed actions to assess if they are consistent with the direction intended for the Park.

1. Cultural, historic and archaeological values

1.1 Ngā Whāinga / Objectives

- (a) The cultural, historical and archaeological values and features of the Park are recognised, protected, enhanced and promoted as appropriate.
- (b) New activities and development do not adversely affect the cultural, historic and archaeological values of the Park.

1.2 Ngā Mahere / Policies

- (a) Recorded HNZPT heritage sites are preserved and protected.
- (b) The design of new buildings and structures, and alterations to existing buildings and structures, including repainting, shall complement the heritage focus of the Park with a view to creating a heritage park atmosphere *NB this is targeted at new buildings and alterations and shall not extend to requiring the redesign or repainting of existing buildings outside of scheduled maintenance.*
- (c) Protect, promote and showcase Pou Tu o Te Rangi Pā.
- (d) Cultural, historic and archaeological educational opportunities are promoted at the Park.
- (e) Opportunities are provided for organised community activities and events that highlight local heritage.
- (f) The Park acknowledges and connects all cultures within the community.

1.3 Ngā Hohenga / Actions

- Require applications for renewal or new licences to occupy, or other development to consider the effects on heritage, cultural and archaeological values. Where necessary this may require an application to include a heritage, archaeological and/or cultural impact assessment.
- Provide and support others to provide, appropriate interpretation of the sites cultural, historic and archaeological values. This may include signage, artwork, sculptures, whakairo, pou whenua, and design of buildings and structures.
- Establish a concept plan with Iwi and Hapū to protect, enhance and promote Pou Tu o Te Rangi Pā. This should include the following:
 - A Waharoa.
 - Whakairo.
 - Consideration of a Whare Taonga (either at the Pā site or incorporated into the museum site or building). This recognises the desire of Iwi to have a place to display their taonga and share their stories.

- Establishing replica palisade fencing, replica whare and other structures on the Pā site to recreate the experience of stepping into a pre-1840s Maori Pā. Such replica structures may be established in other areas of the Park too, recognising that the whole area was once part of an extensive settlement.
- Specific interpretation, signage or artwork.
- Input from an archaeologist to ensure historic features are protected and celebrated and that any reconstruction of the Pā is as authentic/representative as possible.
- Consider linking with adjoining or surrounding sites that add to the heritage values of the Park or wider heritage landscape, if the opportunity arises.
- Provide, or support others to provide, educational information about the Old Mount Wesley Cemetery. This may include information on the history of the cemetery or those buried there, alongside plot and burial information. In particular, this plan supports installing information panels and maps on the Sexton's Shed at the Old Mount Wesley Cemetery.
- Installing a picket fence along Mt Wesley Road from gateway to gateway.

2 Kōrero tuku iho and tikanga (customs and traditions)

2.1 Ngā Whāinga / Objectives

- (a) Kōrero tuku iho and tikanga are integrated into the management and development of the Park.
- (b) The Park is a place where Kōrero tuku iho and tikanga can be learned, lived and experienced.

2.2 Ngā Mahere / Policies

- (a) Acknowledge the spiritual, ancestral, cultural, customary, and historical interests that Iwi have in this Park when making management decisions.
- (b) Enable Iwi and hapū to have a living connection with Pou Tu o Te Rangi and Harding Park.
- (c) Understand, value and apply kōrero tuku iho and tikanga into the management of the Park.
- (d) Te ao Māori and matauranga Māori are incorporated into the management and decision-making for the Park.
- (e) Enable and support mana whenua in environmental participation and kaitiaki roles.
- (f) Management, development, activities and events are considered with acknowledgement of tapu and noa.
- (g) Support and encourage as appropriate, Māori cultural activities and celebrations to occur at the Park.

2.3 Ngā Hohenga / Actions

- Provide and support Iwi and hapū to provide interpretation signage, artwork, sculptures, whakairo, pou whenua, and design of buildings and structures that reflect Kōrero tuku iho.
- Iwi and hapū are kept informed of park development and supported in their role as Kaitiaki.
- Support the relocation of the Rainbow Warrior masts from their current location to an appropriate location off site where their story can better be told. The story of the Rainbow Warrior bombing, while important to New Zealand's national history, has no local connection and interrupts the telling of Pou Tu o Te Rangi's stories.
- Install water receptable at the cemetery gate for cleaning when leaving the cemetery.

3 Views

3.1 Whāinga /Objective

- (a) Views from the Park to the surrounding natural and cultural landscapes and landmarks are protected, maintained and enhanced.

3.2 Ngā Mahere / Policies

- (a) Vegetation management provides for the protection and enhancement of the view shafts identified in Figure 4.
- (b) Activities and new development shall be located, designed or managed in a way that avoids the loss of the identified views.
- (c) Improve viewpoints and, through design, enhance opportunities to access views.

3.3 Ngā Hohenga / Actions

- Park vegetation is managed to protect identified views and viewshafts as shown on figure 4.
- Identify where views could be enhanced by vegetation management on neighbouring properties and discuss with private property owners the possibility of maintenance or removal of vegetation to enhance views from the Park.
- Investigate installing coin operated binoculars at locations that provide significant views.



Figure 4 - Plan showing key view shafts.

4 Ecological values and biodiversity

4.1 Ngā Whāinga / Objectives

- (a) Protect and enhance ecological values and indigenous biodiversity.
- (b) So much as practicable, create the atmosphere of a pre-European environment to complement the Pā site and other heritage elements of the Park.

4.2 Ngā Mahere / Policies

- (a) Preserve, extend and enhance natural ecosystems, indigenous vegetation and native wildlife areas, as appropriate.
- (b) Support initiatives that seek to extend ecological corridors or support ecological linkages for indigenous species to move across the region.
- (c) Retain indigenous vegetation where appropriate.

4.3 Ngā Hohenga / Actions

- Develop a planting plan that:
 - Identifies areas suitable for ecological enhancement planting.
 - Includes plants that will enhance habitat and attract native birds and insects.
- Remove and manage pest plants. Where possible use eco-friendly measures to control the spread of pest plants.
- Investigate improving management of stormwater in the Old Mount Wesley Cemetery.

5 Specimen trees and amenity planting

5.1 Whāinga / Objective

- (a) Park values are maintained, promoted and enhanced through the establishment and management of appropriate specimen trees and vegetation.

5.2 Ngā Mahere / Policies

- (a) All new specimen trees and amenity plantings should be indigenous species, that are eco sourced and appropriate for the site.
- (b) Existing non-native specimen trees, particularly the Liquidambar trees lining the entrance may be retained.
- (c) Maintain and provide trees for:
 - i. Screening and amenity purposes where appropriate;
 - ii. Shade and shelter;
 - iii. Climate mitigation;
 - iv. Ecology.

5.3 Ngā hohenga / Actions:

- Develop a planting plan for the Park that includes:
 - Additional native planting around the stormwater pond.
 - Identifies appropriate areas for weaving, ceremonial purposes and rongoā planting.

- Identifies existing specimen trees to be retained.
- Identifies locations where specimen trees could enhance park values.
- Considers Crime Prevention Through Environmental Design principles.
- Screens and softens buildings where appropriate.
- Permit planting by individuals or groups where it is in accordance with a planting plan, approved by the co-governance committee, or where separate approval has been obtained from the co-governance committee or delegated authority.

6 Recreation and use

6.1 Ngā Whāinga / Objectives

- (a) Continue to provide, and enable others to provide for recreational activities, facilities and experiences (including active, passive and informal recreation) where appropriate.
- (b) Ensure that access to the Park remains free of charge and available to all users with no exclusive use provided for.

6.2 Ngā Mahere / Policies

- (a) Continue to provide areas for passive recreation, including walking, picnicking, bird watching, enjoyment of views, etc.
- (b) Support new initiatives for active and passive recreation activities and experiences that are compatible with the reserve classification, values of the Park, and that are in accordance with the objectives and policies of this Plan.
- (c) Encourage and support the use of the Park for festivals, celebrations and events, where compatible with the reserve classification, values of the Park and are in accordance with the objectives and policies of the Plan.
- (d) Prohibit the permanent operation of commercial activities where exclusive occupation is proposed. This policy does not apply to approved commercial aspects of not-for-profit organisations who have an agreement to operate within the park e.g. museums which as part of their operation included function centre/venue hire, gift shops, charging admission to exhibitions etc.
- (e) Improve security at the Park, particularly at night.

6.3 Ngā Hohenga / Actions

- Maintain and enhance, and where appropriate provide new walking, running and cycling routes.
- Install new picnic tables and seating at appropriate locations in the Park.
- All applications for recreational activities shall be determined by the co-governance committee. Applications shall be based on their effect on park values and their ability to meet the objectives and policies of this plan.
- Encourage and support future development of mountain bike tracks at Harding Park at locations as shown on the concept plan and in consultation with the Mountain Bike Club.
- Investigate locking the gate across the vehicle entrance to the Park at night as a measure to improve security.
- Establish a children's playground in Harding Park. The playground should be in a style that is sympathetic to the historic focus of the park and should incorporate cultural elements.
- Create a shaded picnic area adjacent to the start of the mountain bike tracks with views to the west.

- Consider establishing, or encourage others to establish the following activities at Harding Park:
 - A pentanque court
 - A sculpture park
 - An orienteering course
 - Flying fox or zip line
 - A bike hire facility or service.

7 Access, linkages and connectivity

7.1 Ngā Whāinga /Objectives

- (a) The visitor experience to the Park is improved through connecting all parts of the Park into a coordinated whole experience for visitors.
- (b) Vehicle access and parking is provided and managed in a way that provides for visitor and user needs while ensuring that the Park values are protected and maintained.
- (c) Access is safe and welcoming and available by a variety of means, including disability access.
- (d) The Park is well connected to the surrounding area, including by active transport.
- (e) Access and connections between park facilities and attractions are maintained and strengthened.
- (f) Ensure that the stormwater pond remains suitable as an alternative firefighting water supply.

7.2 Ngā Mahere / Policies

- (a) Improve access and vehicle circulation to improve safety and enhance the visitor experience to the park.
- (b) Continue to provide access and where practicable improve access for buses, hearses, emergency vehicles, campervans and oversized vehicles.
- (c) Ensure that sufficient car parking is available and be responsive to the changing demands for vehicle parking over time.
- (d) Ensure any alterations to vehicle parking areas does not compromise Park values.
- (e) Continue to allow for overflow car parking when required for special events in the locations identified on the concept plan.
- (f) Ensure accessible car parks and other disability access provisions are provided.
- (g) Maintain, promote and enhance pedestrian and cycling access to the Park.
- (h) Provide connections between all activities and facilities (Cemetery, Museum, Heritage Machinery, Mountain Bike tracks and Pou Tu o Te Rangi Pā).
- (i) Information and direction signage is clear and easy to understand and consistently branded.
- (j) The Park feels open and accessible and not exclusive to one set of users.
- (k) Maintain and improve the suitability of the stormwater pond and its access for use as an alternative firefighting water supply.

7.3 Ngā Hohenga / Actions

- Investigate any immediate safety improvements necessary for the existing road layout. Including any additional directional traffic signage required and the installation of a safety guard rail at the sharp corner just past the Pā site.
- Further investigate providing a new two-way vehicle connection to the Park via Old Golf Course Road as shown on the concept Plan. This includes:
 - Restricting the existing entrance into the Park to entry only and one-way circulation.
 - Creating a new vehicle entrance and exit road to Old Golf Course Road.
 - Closing the existing internal loop road off to general vehicle use, whilst maintaining the road for use by pedestrians, cycling, emergency vehicles and other vehicles for events and one off instances.
 - Amendments to the Museum car park to ensure access, parking, private vehicle and bus circulation is achieved.
 - Any design and roading upgrades (operation and safety improvements) that would be necessary for the surrounding road network.

The findings of this investigation are to be presented in a report with a cost benefit analysis comparing this option to other options based around retaining or enhancing the existing road layout. The cost benefit analysis will give consideration to the feedback that was received through consultation on this Plan under sections 41(5) and 41(6) of the Reserves Act 1977. Following the outcome of this analysis, the Plan will be amended in accordance with the increased knowledge, as per section 41(4) of the Reserves Act 1977.

- Investigate combining the Kaipara Heritage Machinery Museum and Mountain Bike Track car parking areas.
- Improve that section of the Historic River Walk which passes through the Park and the Park's connection to the wider Historic River Walk with path improvements and improved signage.
- Install bollards around the picnic area in front of the Lighthouse Function Centre.
- Investigate ways to improve the suitability of the stormwater pond and its access for use as an alternative firefighting water supply, giving consideration to the New Zealand Fire Service Firefighting Water Supplies Code of Practice.
- Maintain the stormwater pond and access to the pond, to ensure it remains as a viable source of firefighting water.
- Seal car parking areas where required.
- Form a proper access to the overflow car parking area.
- Improve access for people with disabilities, mobility scooters, pushchairs and prams.
- Enhance walking and cycling connections to the Park.
- Improve the access from Park Road to the Park by making it more visible and inviting.
- Improve walking and cycling access from Old Golf Course Road.
- Form additional car parking for the Old Mount Wesley Cemetery.
- Upgrade the existing driveways within Old Mount Wesley Cemetery with a focus on creating a defined division between the roadway and burial plots.
- Upgrade existing bike racks and install additional bike racks at strategic places at the Park.

- Provide signage to ensure visitors can find their way around the Park.
- Fencing is to be reprioritised throughout the Park with the aim of removing unnecessary fences to improve connectivity and inclusiveness.
- Work with others including Kaipara Cycling to improve links to other cycling trails/ integrated into other trails.

8 Partnerships

8.1 Whāinga / Objective

- (a) The co-governance committee supports and encourages collaboration and engagement with key stakeholders and the local community.

8.2 Ngā Mahere / Policies

- (a) Seek effective communication between key stakeholders and the co-governance committee.
- (b) Foster involvement of the local community in the management of the Park.
- (c) Work with Heritage New Zealand Pouhere Taonga, Iwi and Hapū and other interested parties to protect, enhance and manage the Parks archaeological and heritage sites.
- (d) Encourage and support volunteering efforts or community projects that benefit the Park, users of the Park or contribute to visitor experience.

8.3 Ngā Hohenga / Actions

- Support the establishment of a 'Friends of Group' with representation of key stakeholders.
- Involve communities in the design of the Park.
- Ensure decision-making is transparent and maintenance reports are available.

9 Licences and permits

9.1 Whāinga /Objective

- (a) To provide for licenses and permits that allow use and activities that are compatible with the reserve classification, park values and the objectives and policies of this Plan.

9.2 Ngā Mahere / Policies

- (a) Applications for licences and permits will be considered and determined by the co-governance committee or delegated authority.
- (b) Encourage co-locating of activities within buildings to optimise use of facilities and public land. Favour non-exclusive use or occupation of an activity.
- (c) Specific matters for consideration prior to renewing an existing or granting a new licence to occupy, or permit include:
 - i. Necessity for the activity to locate within the Park
 - ii. Whether the activity enhances visitor experience
 - iii. The degree of exclusive occupation (if any) associated with the activity
 - iv. Consistency of the activity with this Plan's objectives and policies

- v. Duration of the licence and likelihood of relocation off the site where a short term is proposed
- vi. The demand and effect the proposal will place on existing infrastructure (e.g. roading, parking, stormwater)
- vii. The scale and effect of any physical works necessary to establish the activity
- viii. The compatibility of the activity with the heritage, cultural and landscape values of the Park
- ix. The degree to which the application is supported by Iwi
- x. Where the activity is existing, the costs and benefits in retaining the activity on the site compared with the costs and benefits of the activity vacating the site
- xi. Maintenance roles and responsibilities

9.3 Hohenga / Action

- The co-governance committee will consider and determine applications for licences and permits that have been prepared with adequate consideration given to all the matters listed in 9.2(c) above.



Part 3 – Actions summary and concept plans

The concept plans show a vision for how the Park is intended to be developed. They are intended to be the sum outcome of giving effect to the objectives and policies of this plan and of implementing the actions.

Concept plans

Concept plan 1 – Overall Park

Concept plan 2 – Museum area

Concept plan 3 – Kaipara Heritage Machinery and Mountain Bike Car Park



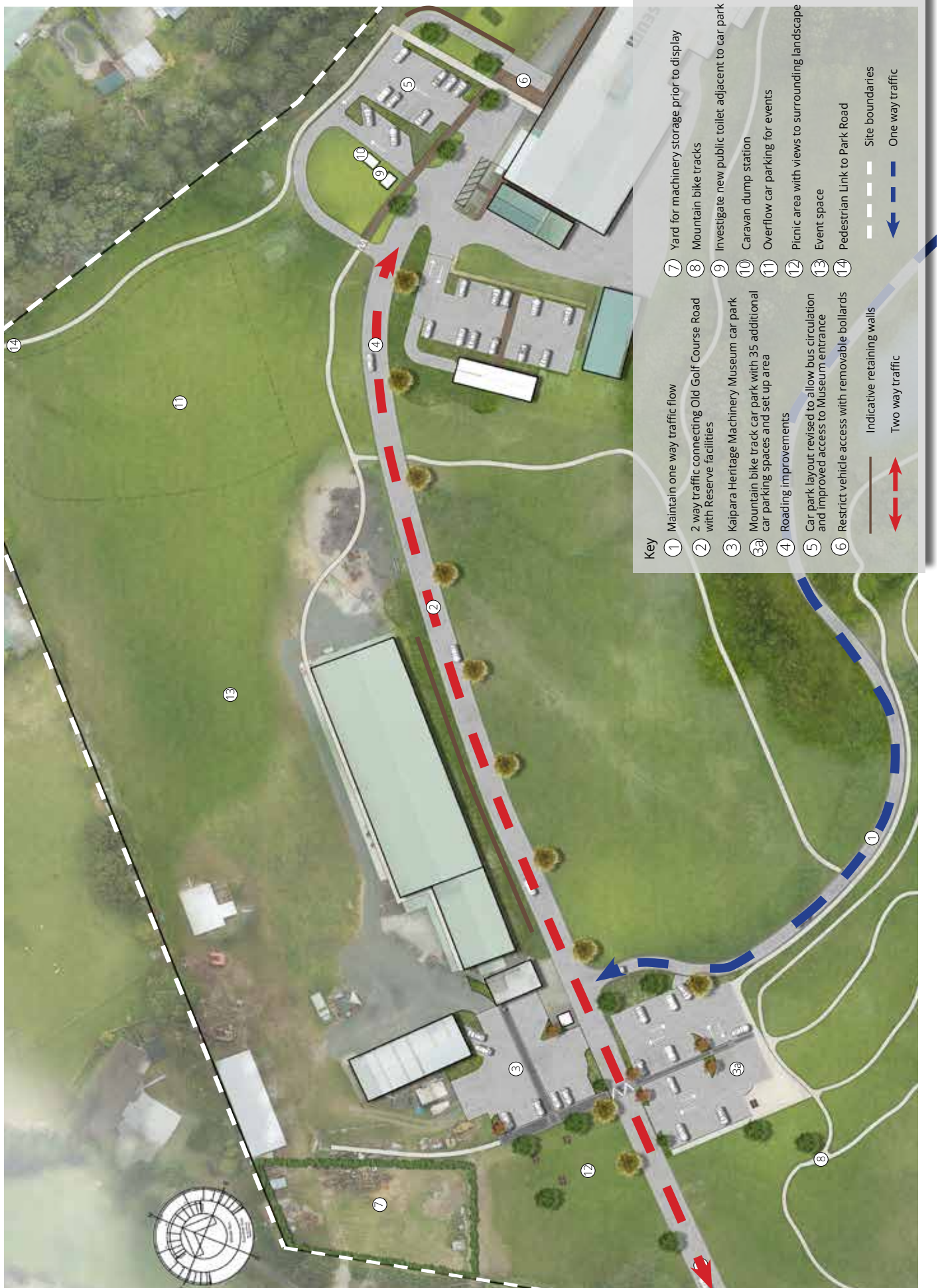



Summary of Actions

Actions will be subject to timing, funding and agencies involved in the delivery of the actions.

	Priority		
	Short term	Long term	On-going
Cultural, historic and archaeological values	Establish a concept plan for Pou Tu o Te Rangī Pā.	Establish replica whare, palisades and other structures at Pou Tu o Te Rangī Pā as directed by the concept plan.	<p>Require applications for renewal or new licences, permits or development to consider the effects on heritage, cultural and archaeological values.</p> <p>Provide and support others to provide interpretation of the site values.</p> <p>Ensure the preservation and protection of recorded HNZPT sites.</p> <p>Consider linking with adjoining or surrounding sites that will add to the heritage values of the reserves.</p> <p>Provide and support others to provide educational information about the Cemeteries.</p> <p>Investigate installing a picket fence along Mt Wesley Road.</p>
Landscape values and views	Investigate installing coin operated binoculars at locations that provide significant views.	Investigate installing interpretation for significant natural and cultural landscapes.	Vegetation is managed to protect identified views and viewshafts.
Kōrero tuku iho and tikanga	Install water receptable at the cemetery gate.		<p>Require applications for renewal or new licences, permits or development to consider the effects on Māori values.</p> <p>Provide and support others to provide interpretation signage, artwork, sculptures, whakairo, pou whenua, and design of buildings and structures that reflect Kōrero tuku iho.</p> <p>Iwi are supported in their role as Kaitiakitanga.</p> <p>Support the relocation of the Rainbow Warrior masts.</p>

	Priority		
	Short term	Long term	On-going
Ecological values and biodiversity	<p>Develop a planting plan for the Park that incorporates ecological enhancement.</p> <p>Investigate improving management of stormwater in the Old Mount Wesley Cemetery.</p>	Remove and manage pest plants.	
Specimen trees and amenity planting	Develop a planting plan for the Park that incorporates design and amenity planting.		Permit planting by individuals or groups where it is in accordance with an approved planting plan.
Recreation and use	<p>Install new picnic tables and seating.</p> <p>Create a shaded picnic area adjacent to the start of the mountain bike tracks with views to the west.</p> <p>Investigate locking the gate across the vehicle entrance to the Park at night as a measure to improve security.</p>	<p>Encourage and support future development of mountain bike tracks.</p> <p>Establish a children's playground in Harding Park.</p>	
Partnerships	<p>Support the establishment of a 'Friends of Group'.</p> <p>Decision-making is transparent.</p> <p>Maintenance reports are available.</p>		Involve communities in the design of the Park.

	Priority		
	Short term	Long term	On-going
Access, linkages and connectivity	<p>Investigate any immediate safety improvements necessary for the existing road layout.</p> <p>Fix pot holes in parking areas.</p> <p>Upgrade existing bike racks and install additional bike racks.</p> <p>Further investigate providing a new two-way vehicle connection to the Park via Old Golf Course Road.</p> <p>Maintain the stormwater pond and access to the pond, to ensure it remains as a viable source of firefighting water.</p> <p>Remove unnecessary fences.</p>	<p>Investigate combining the Kaipara Heritage Machinery Museum and Mountain Bike Track car parking areas.</p> <p>Enhance walking and cycling connections to the Park.</p> <p>Improve access from Park Road by making it more visible and inviting.</p> <p>Seal car parking areas.</p> <p>Improve that section of the Historic River Walk which passes through the Park and the Park's connection to the wider Historic River Walk with path improvements and improved signage.</p> <p>Install bollards around the picnic area in front of the Lighthouse Function Centre.</p> <p>Investigate ways to improve the suitability of the stormwater pond and its access for use as an alternative firefighting water supply.</p> <p>Improve walking and cycling access from Old Golf Course Road</p> <p>Form additional car parking for the Old Mount Wesley Cemetery</p> <p>Upgrade the existing driveways within Old Mount Wesley Cemetery</p>	<p>Improve access for people with disabilities, mobility scooters, pushchairs and prams.</p> <p>Provide wayfinding signage.</p> <p>Improve links to other cycling trails.</p>

Review considerations

Section 41(4) of the Reserves Act 1977 states that Council must keep its management plan under continuous review, so that the plan is adapted to changing circumstances or in accordance with increased knowledge.

This Plan may be subject to minor alterations from time to time, with actions removed and added as needed, and will accordingly be updated.

Council's Significance and Engagement Policy will be used to direct what consultation is needed on a case by case basis in response to the scale of the changes proposed.

Changes to the vision or extensive changes to the objectives would trigger a comprehensive review. Any such comprehensive review would need to follow the full process for making a new reserve management plan as set out in section 41 of the Reserves Act 1977. This process involves full community consultation, including the opportunity for submissions to be made and hearings held.

